



32 Rivermead Court

Marlow Bridge Lane, Marlow, SL7 1SJ

£2,250 Per month



32 Rivermead Court



Description

Situated in an attractive gated development on the banks of the River Thames, this stunning ground floor riverside apartment with lovely communal gardens, is in easy walking distance of Marlow town centre. The property has picturesque views upstream and downstream, as well as across to Higginson Park and the beautiful Marlow bridge.

The property has two bedrooms, separate kitchen and generous sized bathroom along with double aspect lounge/diner with spectacular views, which leads onto the private terrace/balcony which also has an amazing outlook. The apartment has use of 2 parking spaces.

The transport links are excellent with both the M4 and M40 in easy reach via the A404 and Paddington is easily accessed (via Maidenhead) from the town's railway station which is a short walk away. This will be added to by the impending Crossrail Line from Maidenhead, which will make London accessible even more quickly.

- Riverside apartment
- Double aspect reception space
- Fully integrated kitchen
- Beautiful communal gardens
- Available from Early March
- Spectacular views
- Balcony/Terrace
- Two allocated Parking spaces
- Close to Marlow Town Centre
- Unfurnished





Floor Plan

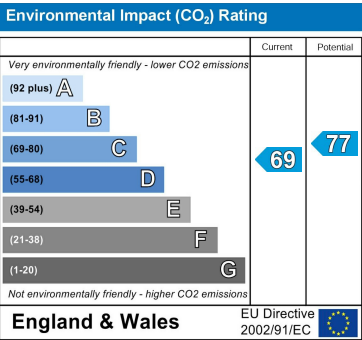
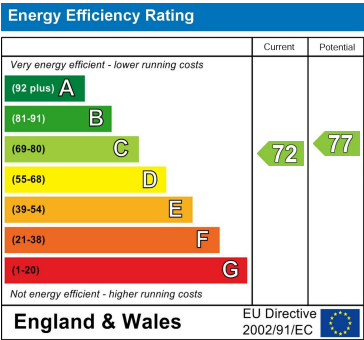
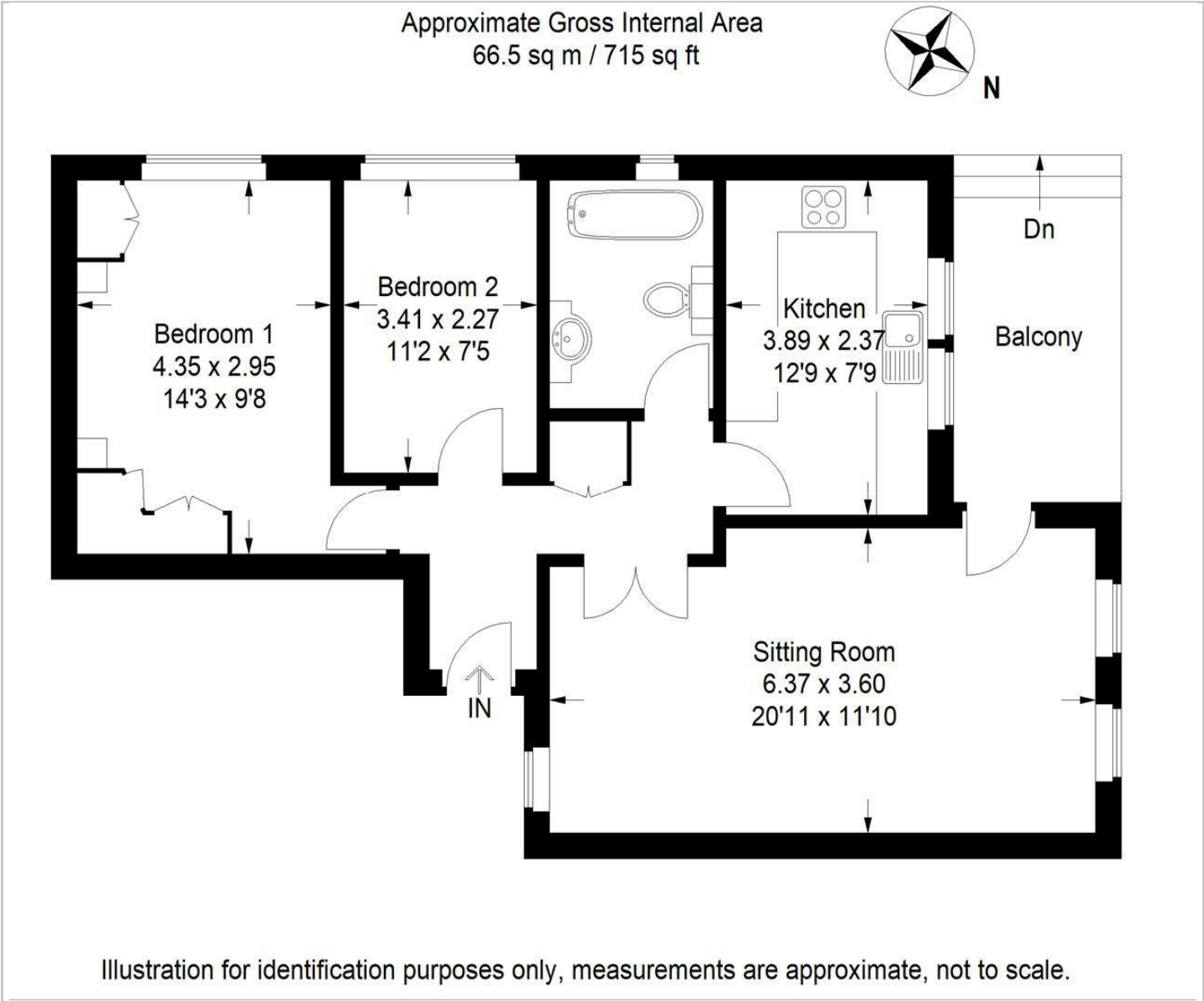

Viewing

Please contact our Head Office Office on 03333444385 if you wish to arrange a viewing appointment for this property or require further information.

These particulars, whilst believed to be accurate are set out as a general outline only for guidance and do not constitute any part of an offer or contract. Intending purchasers should not rely on them as statements of representation of fact, but must satisfy themselves by inspection or otherwise as to their accuracy. No person in this firms employment has the authority to make or give any representation or warranty in respect of the property.

